

SLEUTELLEZER
dashboard

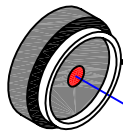

NOOD SLEUTEL
1 sleutel voor alle
voer- werktuigen

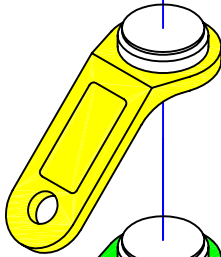

SERVICE SLEUTEL
1 sleutels per
voer- werktuig

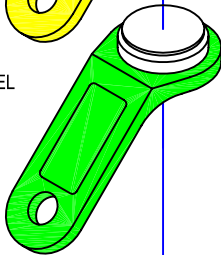

DATA
OPSLAG

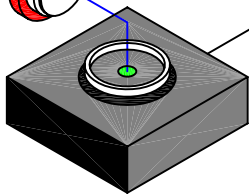
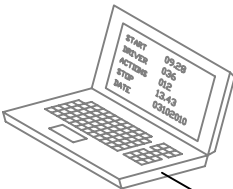
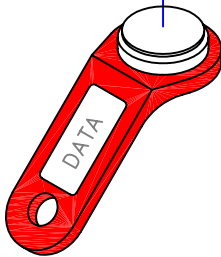

DATA UITLEZEN VIA PC (USB)



Lockstar
TFK1000plus

DEURVERGREDELING
BRANDSTOF AFSLUITER
STARTBLOKKERING
AUTORISATIE CONTROLÉ
DATA REGISTRATIE
● DATUM EN TIJD
● MACHINIST/CHAUFFEUR
● STORINGEN
● GRENSWAARDEN
● ETC.

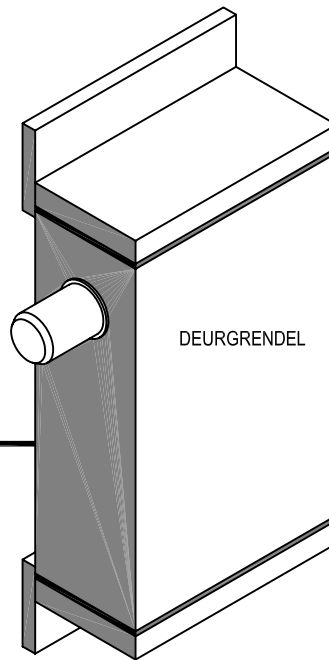

DEURGRENDEL

TRANSPONDERLEZER
grendel

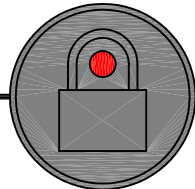

PERSOONS-
GEBONDEN
TRANSPONDERS

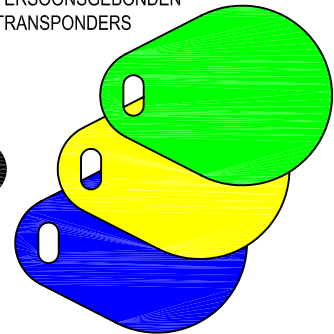

TRANSPONDERLEZER
startonderbreking

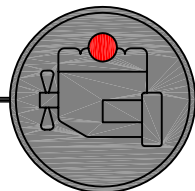

HOOFDSCHAKELAAR

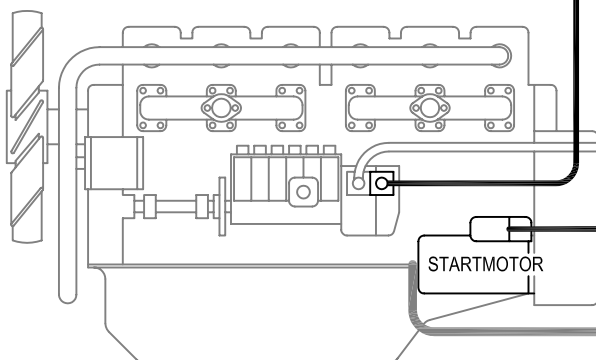
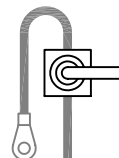

STARTMOTOR

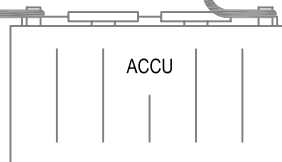

ACCU

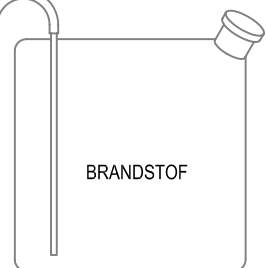

BRANDSTOF

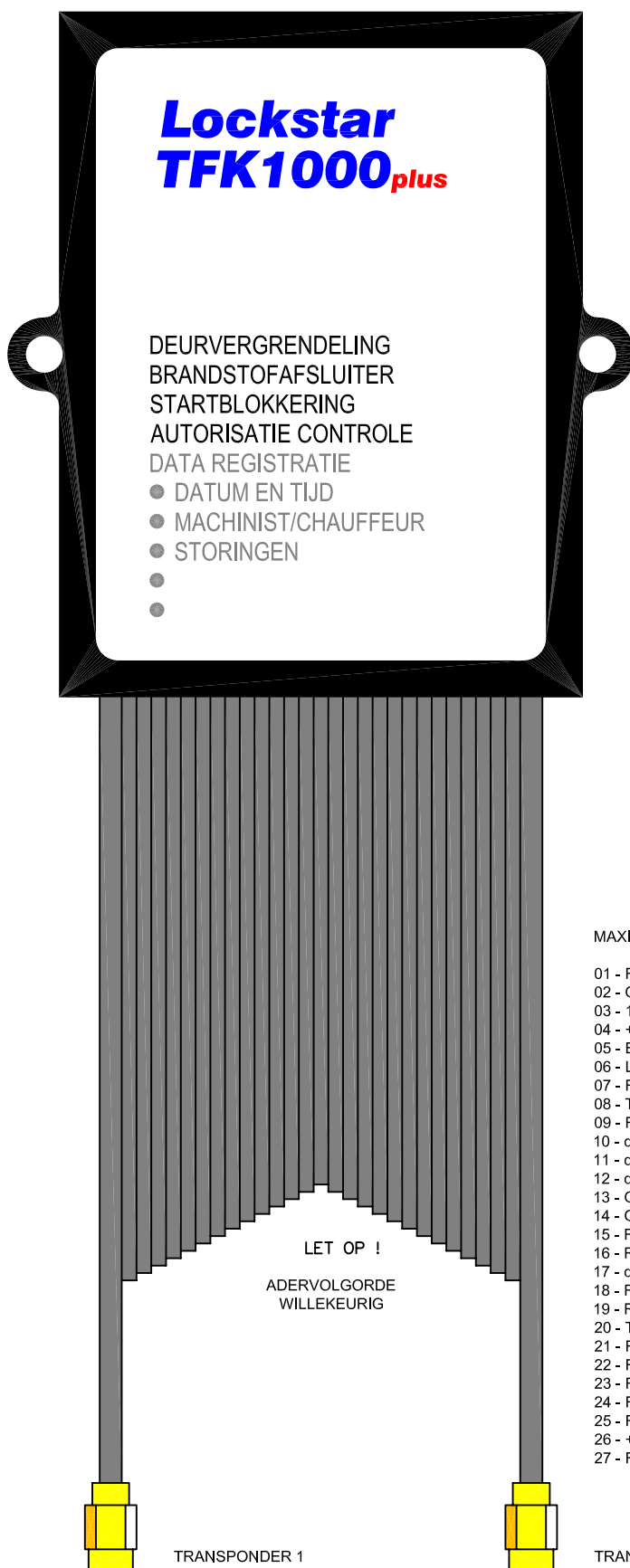

STERK

www.sterk.com

TFK1000plus

Meervoudige beveiliging voor voertuigen en werktuigen

- o deurvergrendeling
- o brandstofblokkering
- o startonderbreker
- o transponder sleutels
- o autorisatie controle
- o registratie met geheugen
- o nood sleutel button
- o alarm (sirene etc.)
- o blackbox (button + pc)
- o gprs-sms module aansluiting

geheugen van tijdstip van ontgrendelen, starten en stoppen door geautoriseerde gebruikers registratie van servicehandelingen, overschrijding van ingestelde grenswaarden en storingen

MAXIMALE CONFIGURATIE

- 01 - RELAIS 1 NC
- 02 - GND (massa)
- 03 - 12V OUT
- 04 - +30 (24V)
- 05 - BUZZER (massa)
- 06 - LED (massa)
- 07 - RELAIS 2 NC
- 08 - TX (communicatie)
- 09 - RELAIS 3 NO
- 10 - detectie ingang (-)
- 11 - detectie ingang (+)
- 12 - detectie ingang (+)
- 13 - GND (TCK)
- 14 - GRENDEL (data)
- 15 - RELAIS 4 NO
- 16 - RELAIS 4 NC
- 17 - detectie ingang (-)
- 18 - RELAIS 4 COM (10A)
- 19 - RELAIS 3 COM (15A)
- 20 - TCK (sleutellezer)
- 21 - RELAIS 3 NC
- 22 - RELAIS 2 NO
- 23 - RX (communicatie)
- 24 - RELAIS 2 COM (15A)
- 25 - RELAIS 1 COM (10A)
- 26 - +15 (24V)
- 27 - RELAIS 1 NO

TRANSPONDER 1

TRANSPONDER 2